



TUI BLUE

TUI BLUE MAKARSKA FACTSHEET

FOR INTERNAL USE ONLY.

HOTEL CONTACT DETAILS

Resort / Hotel Name	TUI BLUE Makarska
Star Rating	4
Display Line Address	Igrane, Croatia Igrane 320 Split 21329 Croatia
Tel	+385 21 604 041
E-Mail	info@tuibluemakarska.com
Homepage	https://www.tui-blue.com/en/en/hotels/tui-blue-makarska
Giata ID	411783
Holidaycheck ID	1462879
TripAdvisor ID	7590945

GENERAL

At the TUI BLUE Makarska, you'll find everything you need for an unforgettable adults-only holiday on the Makarska Riviera. From the infinity pool to the crystal clear waters of the Adriatic Sea, the adults-only hotel offers pure relaxation. Spa, sports, Croatian and international cuisine, as well as the perfect location on the Makarska Riviera make the TUI BLUE Makarska a dream getaway for couples.

USPS

- **BLUEFIT FITNESS AND SPORTS**

Do you want more from your holiday than just relaxation? The TUI BLUE Makarska is definitely the right choice.

- **SPA, WELLNESS AND RELAXATION**

Wellness and relaxation are very important in the spa at the TUI BLUE Makarska. A healthy sweat in the Finnish sauna is exactly what you need after an eventful day.

- **WATERSPORTS**

TUI BLUE Makarska's "crystal clear water" is no exaggeration and is perfect for any type of external water sports.

- **ENTERTAINMENT AND EDUTAINMENT**

Take unique experiences home from the TUI BLUE Makarska with our edutainment offer.

HOTEL TYPE	ESPECIALLY SUITABLE FOR	LOCATION
Adults Only	Business People	At the Seaside
Bed & Breakfast	Couples	In a Bay
Bungalow Complex	Food Lovers	On/By the Beach
Club/Resort Hotel	LGBTQ+	Quiet Environment
Holiday Hotel	Singles	
Holiday Resort		
Rural Hotel		
Spa & Wellness		
Sports & Activities		

FOR INTERNAL USE ONLY.

KEY FACTS

Number of Buildings (Guest House, Main Building)	7
Buildings Stories	6
Property Size	15000m2
Date of Last Renovation	2015
Hotel Chain	TUI Hotels & Resorts
Degree of Latitude	43.1937833
Degree of Longitude	17.13980535
Total Number of Rooms	179
Total Number of Beds	358
Number of Standard Double Rooms	89
Number of Superior Double Rooms	Superior double rooms: 57; superior twin rooms: 8
Number of Comfort Double Rooms	79
Number of Suites	14
Number of Non-smoking Rooms	179
Number of Accessible Rooms	3 Standard double room; 1 superior rooms. but hotel itself is not the best choice for people with walking issues, because of many stairs to the beach and pool
Accessible Rooms	Yes
Hotel Company	TUI Hotels & Resorts

DIRECTIONS

Directions Via Car	Additional price for hotel's parking place (5 euros per day)
Directions Via Train	Possible until Split train station; from Split to Igrane with car/taxi/bus
Directions From Airport	Split (SPU) airport approximately 120km
Free Station Transfer	✓ Taxis can be arranged with the hotel at a cost
Free Airport Transfer	✓ Included with some TUI Package
Paid For Airport Transfer	✓ Taxis can be arranged with the hotel or booked at the airport

FOR INTERNAL USE ONLY.

ROOM DETAILS

DOUBLE ROOM

EXTERNAL BUILDING

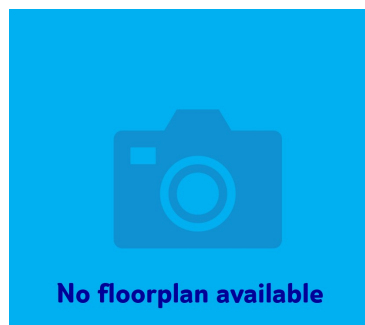

Dimensions	24/26m ²
Number of Bedrooms	1
Number of Bathrooms	1
View	Inland, Garden, Sea side, Sea view and Swim up rooms available
Specialties	230V power, UK socket at desk
Details	Min/Max. occupancy 1-2 person

ROOM FACILITIES

NOTES

Air Conditioning	✓
Balcony/Terrace	✓
Bathroom with Shower	✓
Cable TV	✓
Desk	✓
Flat Screen TV	✓
Garden Furniture	✓
Hairdryer	✓
Iron & Ironing Board	✓
Makeup Mirror	✓
Minibar	Charged
Room Safe	✓
Room Service	✓
Satellite TV	Selection of international channels
Suitcase Stacking	✓
Tea/Coffee Maker/Machine	Kettle
Telephone	✓
Toiletries	✓
Wi-Fi	✓

DOUBLE ROOM

EXTERNAL BUILDING

FOR INTERNAL USE ONLY.



Dimensions	24-26m2
Number of Bedrooms	1
Number of Bathrooms	1
View	Inland or park view
Specialties	230V power, UK socket at desk, some rooms have no balcony
Details	Min/Max. occupancy 1-2 person

ROOM FACILITIES

NOTES

Air Conditioning	✓
Balcony/Terrace	✓
Bathroom with Shower	✓
Cable TV	✓
Desk	✓
Garden Furniture	✓
Hairdryer	✓
Iron & Ironing Board	✓
Makeup Mirror	✓
Minibar	Charged
Room Safe	✓
Room Service	✓
Satellite TV	Selection of international channels
Suitcase Stacking	✓
Tea/Coffee Maker/Machine	Kettle
Telephone	✓
Toiletries	✓
Wi-Fi	✓

SUPERIOR DOUBLE ROOM

EXTERNAL BUILDING

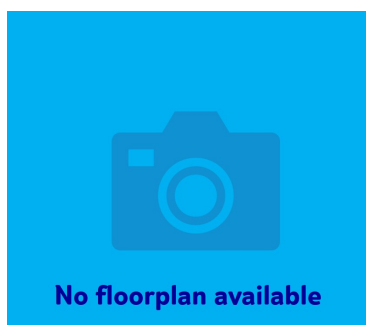

Dimensions	26-30m2
Number of Bedrooms	1
Number of Bathrooms	1
View	Inland , Sea side & Seaview available
Specialties	230V power, UK socket at desk
Details	Min/Max. occupancy 1-2 person

FOR INTERNAL USE ONLY.

ROOM FACILITIES	NOTES
Air Conditioning	✓
Balcony/Terrace	✓
Bathrobe	✓
Bathroom with Shower	✓
Cable TV	✓
Desk	✓
Flat Screen TV	✓
Garden Furniture	✓
Hairdryer	✓
Iron & Ironing Board	✓
Makeup Mirror	✓
Room Safe	✓
Room Service	✓
Satellite TV	Selection of international channels
Suitcase Stacking	✓
Tea/Coffee Maker/Machine	Kettle
Telephone	✓
Toiletries	✓
Wi-Fi	✓

JUNIOR SUITE

EXTERNAL BUILDING

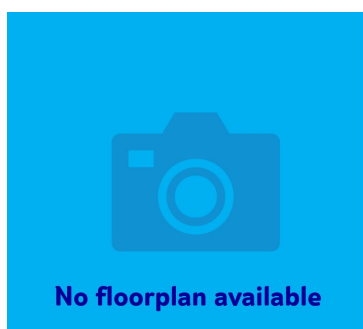

Dimensions	30m2
Number of Bedrooms	1
Number of Bathrooms	1
View	Mountain, Seaside & Sea view rooms available
Specialties	230V power, UK socket at desk.
Details	Min/Max. occupancy 1-2 person

ROOM FACILITIES	NOTES
Air Conditioning	✓
Balcony/Terrace	✓
Bathrobe	✓
Bathroom with Shower	✓
Cable TV	✓

FOR INTERNAL USE ONLY.

ROOM FACILITIES	NOTES
Desk	✓
Flat Screen TV	✓
Garden Furniture	✓
Hairdryer	✓
Iron & Ironing Board	✓
Makeup Mirror	✓
Minibar	Refill 4 times per week for AI guests
Room Safe	✓
Room Service	✓
Satellite TV	Selection of international channels
Slippers	✓
Suitcase Stacking	✓
Tea/Coffee Maker/Machine	✓
Telephone	✓
Toiletries	✓
Wi-Fi	✓

EATING AND DRINKING

KEY FACTS

• Number of Restaurants	2
• Number of Bars	3
Main Restaurant	The Restaurant
Bars	The bar, 2 x pool bars
Speciality Restaurants	Culinarium

CUISINE

Board Basis

Bed & Breakfast	✓
Half Board	✓

Type of Restaurants & Bars

Buffet Restaurant	✓
Pool Bar	✓
À la Carte/Specialty Options	✓

FOR INTERNAL USE ONLY.

Dietary/Lifestyle Requirements

Diabetic Friendly	✓
Gluten Free	✓
Vegan	✓
Vegetarian	✓

Additional Options

Afternoon Tea	✓
BBQ	✓
Gala Dinner	✓
Late Breakfast	✓
Packed Lunch	✓
Room Service	✓

FOR INTERNAL USE ONLY.

RESTAURANTS



Name	The Restaurant
Details	The main buffet
Restaurant Details	Waiter service
Bar Details	Bar service
Offerings	Theme nights several times a week
Dresscode	Appropriate clothing during dinner
Opening Hours	07:00 - 11:00am, 18:30 - 21:00 or 21:30 in high season
Location	In the main hotel area



Name	Culinarium
Details	Mediterranean A la Carte
Restaurant Details	Waiter service
Bar Details	Bar service
Reservation	Via BLUE app, BLUE Guide Manager, Culinarium restaurant manager
Dresscode	Appropriate clothing during dinner
Opening Hours	11:00 - 22:00 (Kitchen closes at 2100)
Location	Next to the main building and annex, next to the sea
Specials	Additional charge for BB/HB guests.

BARS

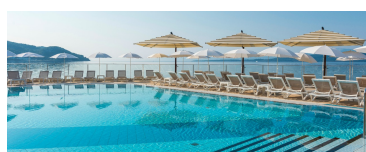

Name	Pool snack bars
Details	Alcoholic & non-alcoholic beverages and cocktails plus snacks
Restaurant Details	Waiter service
Bar Details	Bar service
Opening Hours	Punta Pool bar (9am-6pm); Sunset Pool bar (10 am-6pm)
Location	Pool area
View Details	Pool views
Specials	Snacks at the pool bars every day, additional charge.

FOR INTERNAL USE ONLY.



Name	The Bar
Details	Alcoholic & non-alcoholic beverages and cocktails
Bar Details	Waiter service
Opening Hours	12:00 - 00:00,
Location	Lobby
Specials	Additional charge

FOR INTERNAL USE ONLY.

ACTIVITIES & ENTERTAINMENT

Please download the TUI BLUE APP for the full detailed programme

FITNESS

Included for free

Aqua Fitness	
Group Fitness Classes	
Gym	
Relaxation/Meditation	
Step Aerobics	
Stretch & Relax	
Yoga	

WELLNESS

Included for free

Relaxation Area	
Sauna	
Spa	WeWellness and Spa area

At extra cost

Beauty Treatments	Facials, manicure, pedicure,
Massages	massages: classic, foot reflex zone, lomi, aroma oil, whole body, certain body parts,

DAYTIME SPORTS & ACTIVITIES

Included for free

Hiking/Walking	
Language courses	
Shuffle Board	Sjoelbak and Bocca Ball
Table Tennis	

At extra cost

Excursions	Book with guest relations or TUI
------------	----------------------------------

EVENING ENTERTAINMENT

Included for free

FOR INTERNAL USE ONLY.

Gala Night	Once a week "The Night" BB guests are charged
Live Music	
Open Air Cinema	
Quizzes	
Sundowners	



FOR INTERNAL USE ONLY.

GENERAL HOTEL FACILITIES

Facility	Notes
Air Conditioning	Centrally controlled in Main building; individually controlled in Annex
Beach	
Billiard Table	
Cash Point	Outside the hotel
Doctor/Nurse	On request charged
First Aid	
Games Room	
Garden Patio	
Gym	
Hotel Shops	Souvenir shop
Lift	3 in main building
Outside Pool	Two outside pools (Main pool and infinity pool)
Parasols	
Parking Area	
Reception	
Smoking Area	
Sunbeds	
Sunloungers	
Terrace	
Wi-Fi in Public Areas	Wi Fi is available everywhere, except on the beach. Beach is public.

CONGRESS & CONFERENCE ROOMS

Quantity of Conference Rooms	1
Total Capacity	50 People
Wi-Fi Cost Per Hour	Free
No. of Pax U Plan	
No. of Pax Cabaret Style	
No. of Pax Theatre Style	
No. of Pax Boardroom Style	

EQUIPMENT OF MEETING & CONFERENCE ROOMS

Air Conditioning	✓
Congress Support	✓
Wi-Fi	✓

FOR INTERNAL USE ONLY.

SERVICES & LOCAL INFORMATION

24-Hour Reception	Currency exchange 0700-2100 only
ATM	
Beach/Pool Towels - Free	
Bike Rental	External provider - charged
Car Hire	
Change of Bedding	Every third day, or more often upon request
Change of Towels	If they are left on the floor (sticker with information on the wall, close to towels)
Currency Exchange	
Excursion Information Desk	
Excursions, Tours, Attractions and Event Tickets	
Hairdresser	Additional charge close to hotel 3rd party
Hotel/Club Shops	
Hotel Doctor	on request
Laundry Service	Charged
Luggage Storage	
Multi-lingual Personnel	
Porter Service	
Shuttle Bus	For a charge
Support for Tour and Trip Planning	
Towels At The Beach	In Spa
Towels At The Pool	In Spa
Wake-up Service	

FACILITIES ON SITE / PROXIMITY TO HOTEL

Facility	On Site	Notes
Beach	✓	
Bike Rental		3km Živogošće, 10km Podgora (different bikes)
Boat Rental		3km Živogošće, 10km Podgora
Closest Airport		SPU - Split airport 120km
Closest City		17km Makarska, 80km Split
Doctor		10km Podgora
Football Grounds		17km Makarska
Hiking Trails		1km
Lake		50km Imotski
Shopping Options		17km Makarska
Tourist Centre		Igrane 300m
Train Station		75 km

FOR INTERNAL USE ONLY.

ACCEPTED PAYMENT METHODS

American Express	✓
Bank Transfer	✓
Diners Club	✓
Electronic Cash	✓
Invoice to Company	✓
Local Currency (Cash)	✓
Master/EuroCard	✓
TUI Card	✓
VISA	✓

GENERAL SECURITY & SAFETY

CCTV	✓
Emergency Exit on Every Floor	✓
Fire Certificate	✓
Fire Detector	✓
Hotel Staff Trained in Case of Emergencies	✓
Illumination in Park	✓
Security Personnel	✓
Smoke Detector	✓
Sprinkler	✓
Ventilated Staircases	✓

FOR INTERNAL USE ONLY.

HOTEL ACCESSIBILITY

Adapted Rooms	Notes	
General Hotel/Club Facilities		
Considered Generally Suitable for Guests in a Wheelchair/With Reduced Mobility ?	✗	
Wheelchair Adapted Rooms ?	✓	
Possibility to Rent a Wheelchair ?	✗	
Cost to Rent a Wheelchair	Can't rent wheelchairs	
Elevator Door Width	90 cm	
Are All Areas Accessible For Wheelchair Users/Users With Reduced Mobility By Ramps and/or Elevators?	✗	
Areas Inaccessible For Those in a Wheelchair/With Reduced Mobility	The hotel only has areas accessible by stairs or steps - Beach, pools, a la carte restaurant	
Swimming Pool(s)		
Hotel Accessibility of Swimming Pool	✗	
Pool Steps - Number of Steps	21	
Pool Ladder - Number of Steps	4	
Pool Ramp Available	✗	
Pool Lift Available	✗	
Location of Bathrooms For Those With Additional Needs	Lobby	
Location of Refridgerated Medication Storage	Reception	
Hotel/Club Location / Environment		
Flat	✗	
Slightly Rising or Descending Landscape	✓	
Hillside	✓	
Paved Sidewalks / Streets	✓	
Paved Way to The Beach Promenade	✓	
Paved Way to The Beach	✗	
Rooms	Adapted	Standard
Adapted Category/ies	Standard Double room	
Number of Adapted Rooms	4	
Adapted Room Location	Ground floor; Main building and Bungalow nearby	
Maximum Occupancy	2	
Doors Widths		
Entrance Width	86 cm	81 cm
Bedroom Width	110 cm	81 cm
Living Room Width		
Bathroom Width	101 cm	

FOR INTERNAL USE ONLY.

HOTEL ACCESSIBILITY

Adapted Rooms	Notes	
Balcony Width	118 cm	
Bathrooms		
Adapted Bathtub	✗	✗
Adapted Shower	✓	✗
Wheel-in Shower	✗	✗
Shower Seat	✗	✗
Support Shower	✗	✗
Support Bathtub	✗	✗
Support/Grab Rails Near WC	✓	✗
Enough Wheelchair Turning Room/Floor Space Next to the WC	✓	✗
Wheelchair Space, From Left Frontal View of WC	✓	✗
Wheelchair Space, From Right Frontal View of WC	✗	✗
Washbasin Accessible With Wheelchair	✓	✗
Entry Height of the Shower	17 cm	
Entry Height of the Bathtub		
Height of the Basin	81 cm	
Height of the Toilet	42 cm	
Any Additional Information		
Entry height of the shower: 2 rooms-0; 2 rooms: 17 cm		

FOR INTERNAL USE ONLY.

SUSTAINABILITY

CERTIFICATES

ACTIONS

Biodiversity and ecosystems
Destination & community
Food
Energy
Waste
Water

FUNFACTS